

No. of Courses	Bearings down Logahanna Creek	distances
1	N 51 E	142
2	N 30 E	147
3	N 51 E	48 1/2
4	N 35 E	69
5	N 20 E	43
6	N 21 W	20
7	N 62 W	28
8	N 83 W	45
9	S 58 W	24
10	S 17 W	60
11	S 69 W	75
	N 71 W	32
Total dist:		733 1/2

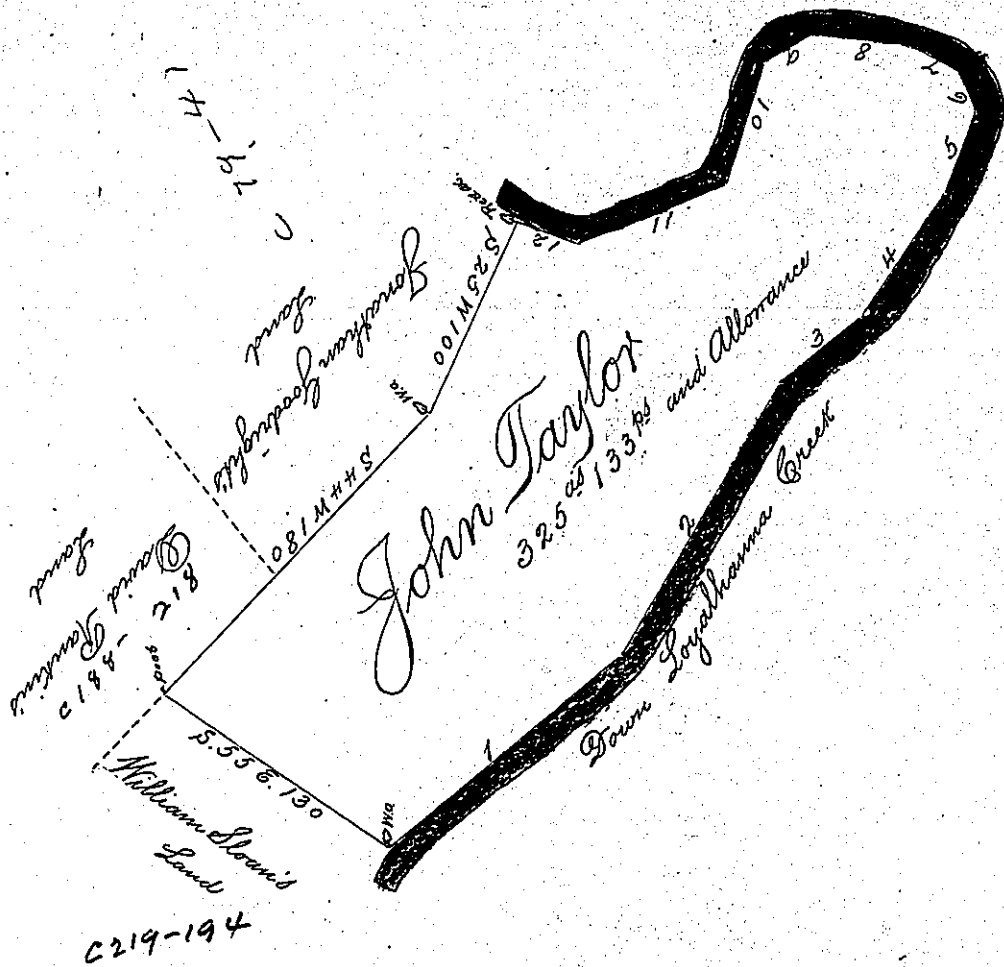

In pursuance of a Warrant dated Dec^r 29th 1784 was Surveyed for John Taylor the above described Tract of Land (Called Scruby Bottom) Containing Three Hundred & Twenty five Acres and one Hundred and Thirty three perches with an allowance proportioned to six p. Cent. Situation in Mountpleasant Township Westmoreland County adjoining Land of William Sloan and others Survey'd April 15th 1785

John Moore D.S.

To John Lukens Esquire }
Surveyor General }

IN TESTIMONY that the above is a copy of the original remaining on file in the Department of Internal Affairs of Pennsylvania, made conformably to an Act of Assembly approved the 16th day of February, 1833, I have hereunto set my Hand and caused the Seal of said Department to be affixed at Harrisburg, this fifth day of November 1907.

James W. Latta
Secretary of Internal Affairs.